

SunWize Power & Battery Mount Installation Guide Roof Ground Mount



Included Parts:

A) 2x Module Rail



B) 2x Tilt Leg Tube

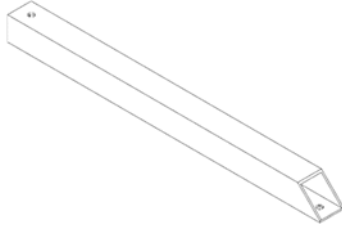

C) 2x Tilt Leg Strut

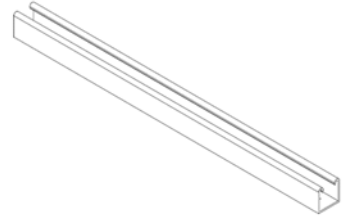

D) 4x Angle Bracket

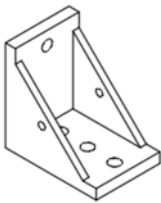

E) 3/8" Spring Nut

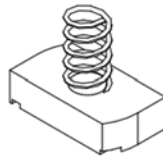

F) 3/8" Flange Bolt



G) 5/16" Flange Bolt

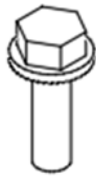

H) 1/4" Flange Bolt

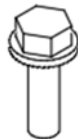

I) 5/16" Flange Nut



J) 1/4" Flange Nut



K) 1x Anti-Seize Packet

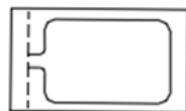

Mount Assembly and Installation: (RGM) Roof Ground Mounts

Standard RGM mounts:

Part #	Rail Length (inches)	Min/Max Tilt (degrees)	Max Module Qty. (Large Format)	Max Module Qty. (Small Format)
240037	96	30-60	2	3
240036	60	30-60	1	2

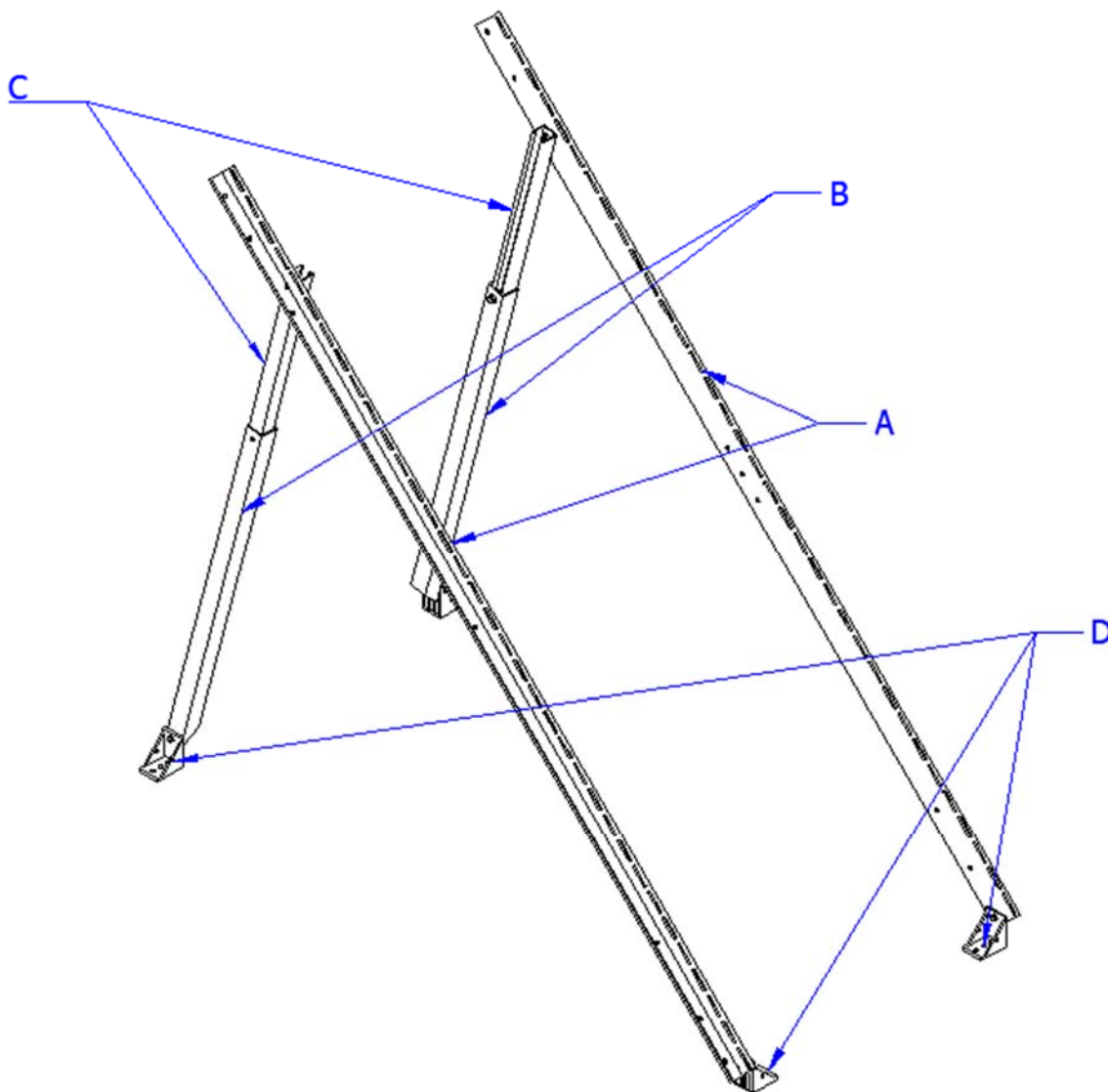

Hardware Note:

- Apply anti-seize to all hardware to prevent galling
- 1 ft-lb = 12 in-lb = 1.36 Nm
- Use 5/16" hardware → Mount assembly
- Use 1/4" hardware → Mounting module to rails
- Use 3/8" bolts → Tilt leg spring nuts

Ground Site Preparation

- The foundation for the array can be any of the following options:
 - Poured reinforced concrete slab
 - Poured reinforced concrete footing pier
 - Structural steel or treated lumber beam supported on reinforced concrete footing pier
- All concrete is to be engineered to meet ASTM requirements for local soil conditions. Surface should be level and free of cracks or voids.
- All footings are to be on firm compacted soil a minimum of 6" below frost line.
- Fasteners are to be stainless steel, 1/2" diameter suitable for self-anchoring into concrete surfaces.
- Ensure modules face true south if located in the northern hemisphere

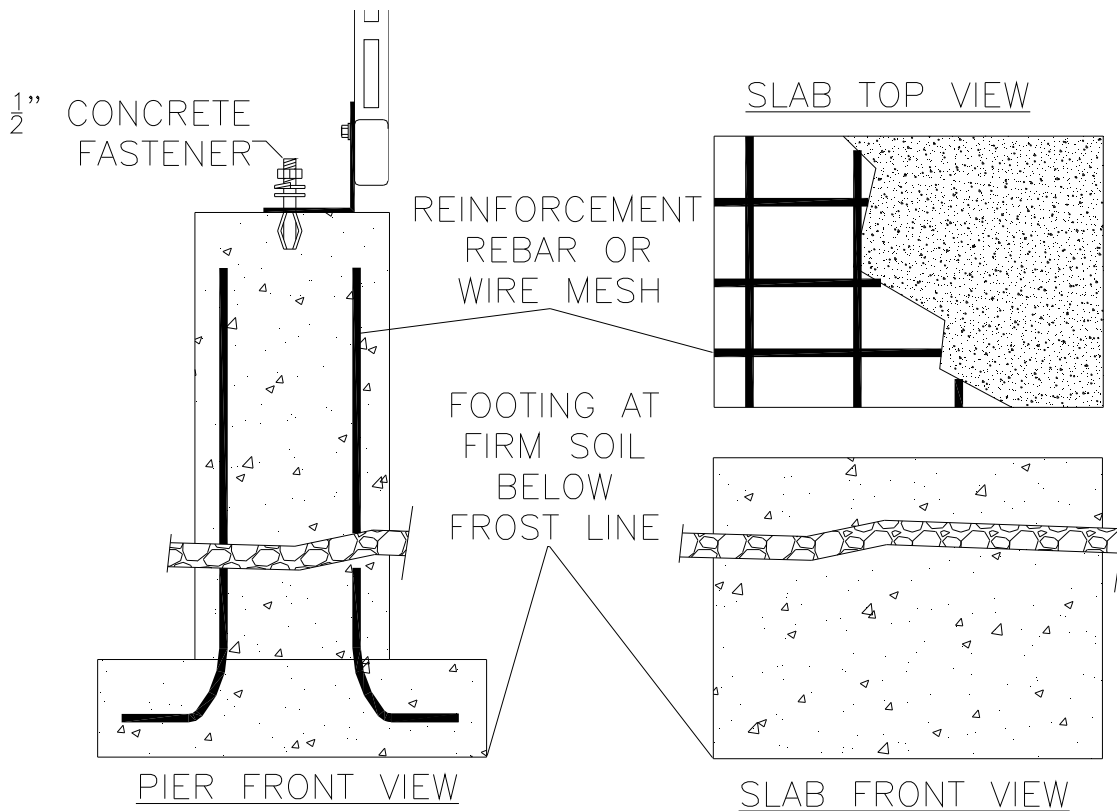

Mount Installation

1. Place your solar modules face down on a flat, smooth surface that will not scratch the glass. Mount the rails to the module holes using the 1/4"-20 x 3/4 hardware provided.

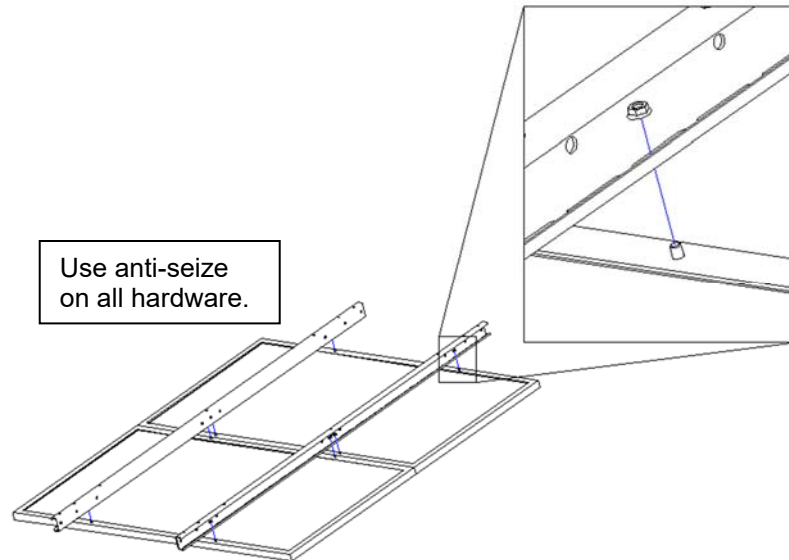

2. Drop spring nut into tilt leg strut and rotate to lock into place. Slide strut and spring nut into tilt leg tube and adjust to desired length. Longer legs increase tilt, shorter legs decrease tilt.

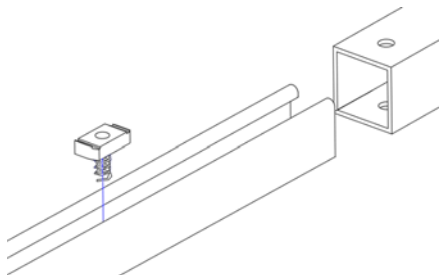

Mount Angles vs Leg Extension (Z)		
Degrees	60.5in Rail	96.25in Rail
30	4in	4in
45	11in	22in
60	18in	34in

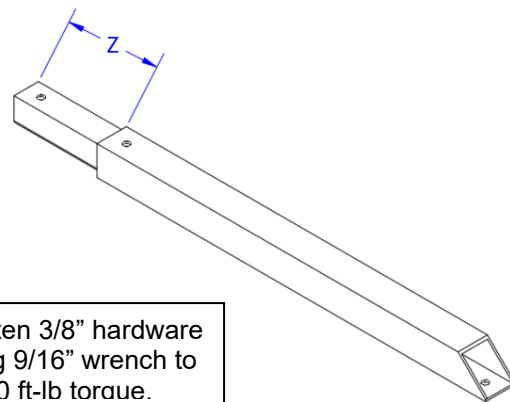
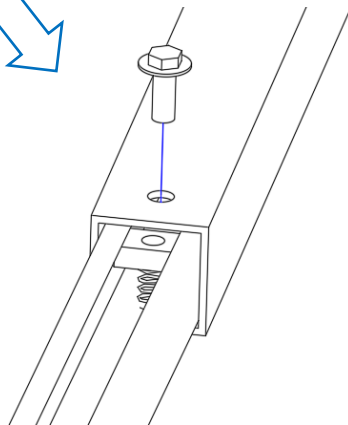

Tighten 3/8" hardware using 9/16" wrench to 18-20 ft-lb torque.

3. Attach the tilt legs towards the other end using the 5/16" hardware provided.

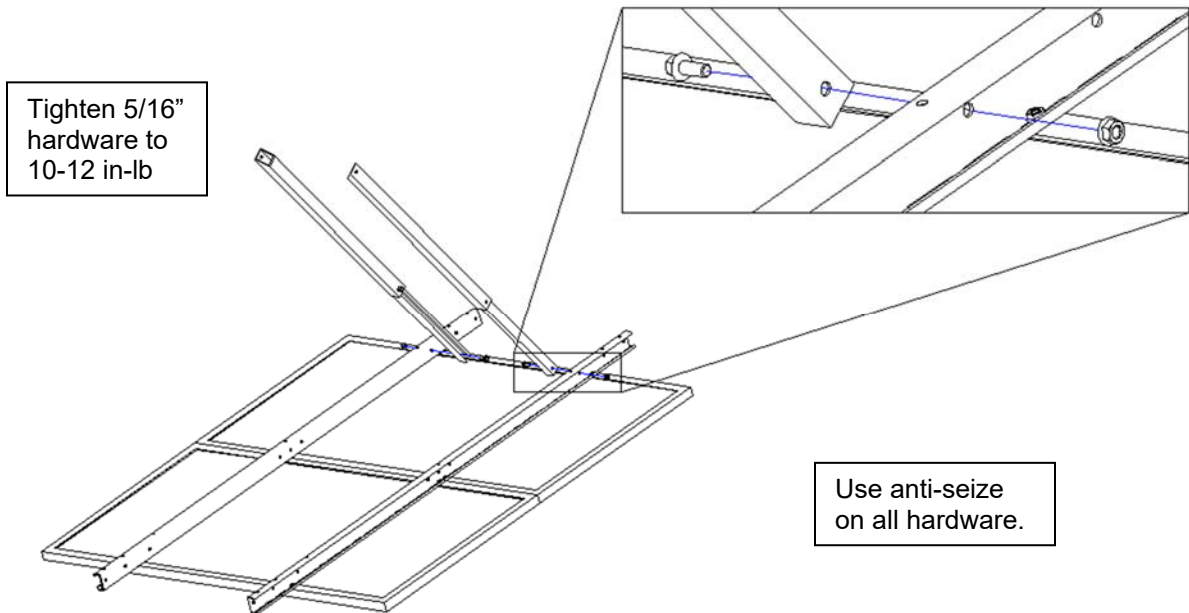

4. Attach the rear mounting feet to the ends of the tilt legs and rails using the 5/16" hardware provided.

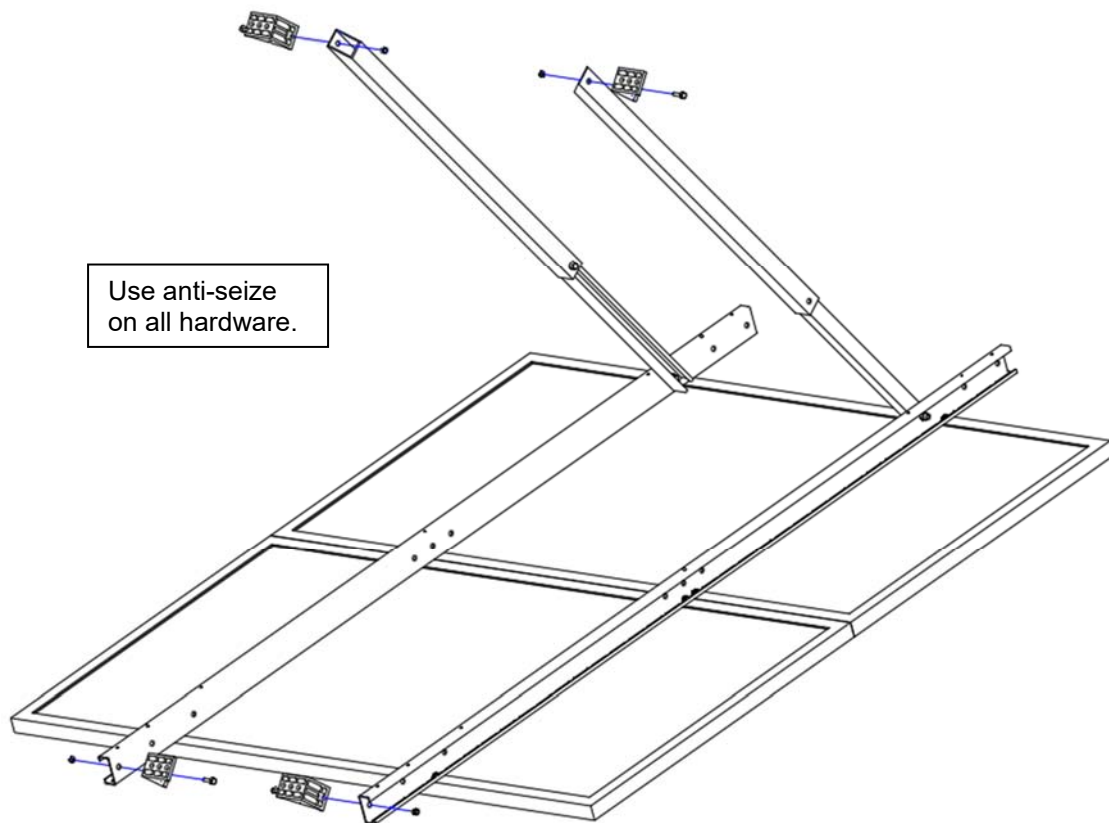

5. Flip the assembly then mount to concrete pad, pallet or other ballasted structure. Use table for approximate foot spacing.

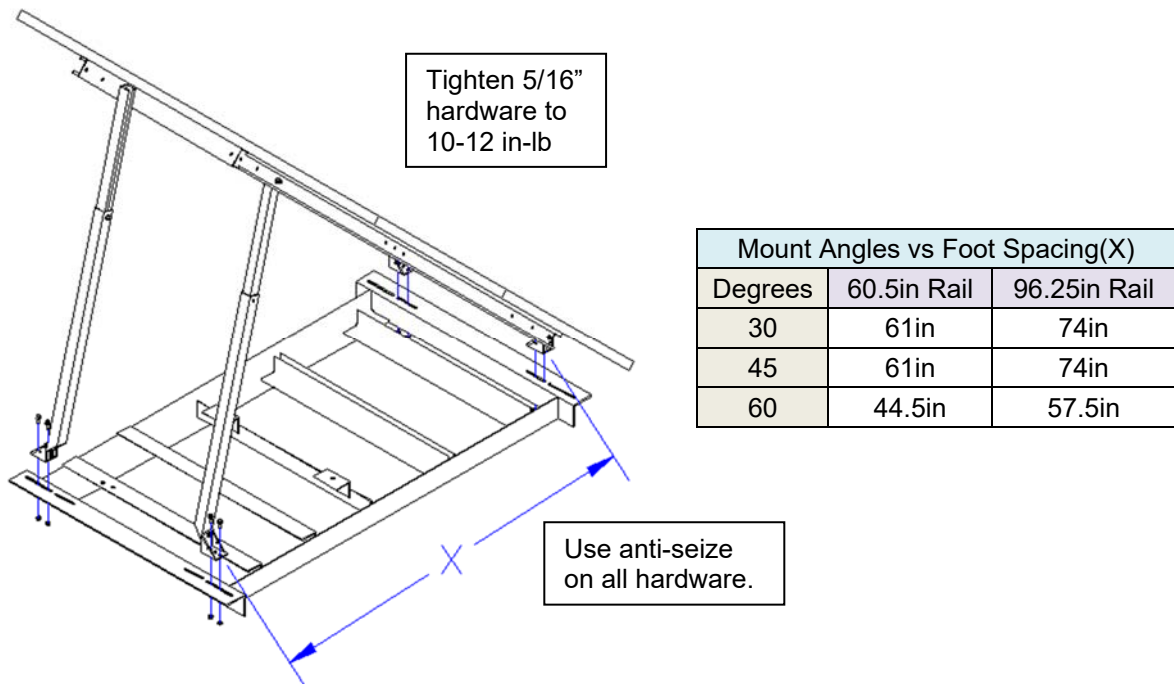

(Optional) Attach the assembly to the *SunWize Steel Ballasting Skid* using the 5/16" hardware provided with the skid. For mounting an enclosure, reference the *SunWize Steel Ballasting Skid Manual*; 310117.

6. Check alignment of all assembled parts and ensure all bolted connections are tight.

