

C1D2 SOLAR MODULE (320W / 24V)

270191

30W

50W

65W

80W

110W

160W

180W

195W

320W

High quality C1D2 rated solar module provides reliable solar electric power for industrial applications including monitoring and control, security, telecom, instrumentation, communications, and general battery charging.

Up to two bypass diodes protect against hot-spot damage during partial shading.

The junction box has four half-inch conduit knockouts. This module features UL1703, C1D2, and CE certifications.

ELECTRICAL SPECIFICATIONS

Rated Power (watts)	320W
Voc Open Circuit Voltage (Volts)	45.44V
Isc Short Circuit Current (Amps)	8.89A
Vmp Rated Voltage (Volts)	38.31V
Maximum Power Current (Amps)	8.36A
Max System Voltage (VDC)	600V
Series Fuse Rating (Amps)	15A

DIMENSION AND WEIGHTS

Module Size (LxWxD) inches	77.00 x 38.90 x 1.94
Module Size (LxWxD) mm	1956 x 988 x 50
Weight (lb/kg)	46.29 / 21.00

ELECTRICAL/THERMAL PARAMETERS

Voltage Temperature Coefficient (Voc)	-0.31%/°C
Current Temperature coefficient (Isc)	0.05%/°C
Power Temperature coefficient (Pmax)	-0.36%/°C
Peak Power Tolerance	+/- 3%
Temperature Range	-40°C to +85°C

CERTIFICATIONS AND STANDARDS

UL 1703, ULC/ORD - C1703-01,
Class 1 Division 2 Group A,B,C, and D

WARRANTY

Five years on material, ten years on performance, 20 years on performance (pro-rated based on performance degradation)



C1D2
RATED

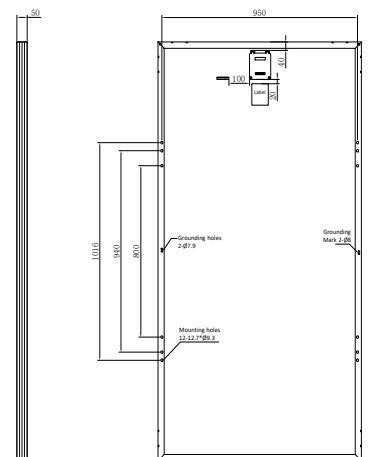
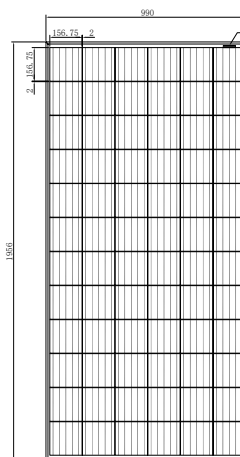

SHOP NOW



LOCATIONS
Oregon Warehouse
New York Warehouse
(866) 827-6527

