

Solar Modules (320W / 24V)

High quality modules for industrial applications. Top-quality performance for all solar electric power applications such as monitoring and control, security, instrumentation, telecom, and general battery charging. Up to (2) bypass diodes protect against hot-spot damage during partial shading. Junction box has (4)-1/2" conduit knockouts and features UL-1703, C1D2, and CE certifications.

SWPB Part #	020295
Rated Power (Watts)	320W
Voc Open Circuit Voltage (Volts)	45.44V
Isc Short Circuit Current (Amps)	8.89A
Vmp Rated Voltage (Volts)	38.31V
Imp Rated Current (Amps)	8.36A
Max System Voltage (VDC)	600
Series Fuse Rating (Amps)	15
Dimensions and Weights	
Module Size (l x w) inches	77.0 x 38.9
Module Size (l x w) mm	1956 x 988
Weight (lb / kg)	46.29 / 21.0
Electrical / Thermal Parameters	
Voltage Temperature coefficient (Voc)	-0.31%/°C
Current Temperature coefficient (Isc)	0.05%/°C
Power Temperature coefficient (Pmax)	-0.36%/°C
Peak Power Tolerance	+/-3%
Certifications & Standards	
UL 1703, ULC/ORD - C1703-01, Class 1 Division 2 Group A,B,C, and D	
Warranty	
5 years on material, 10 years on performance, 20 years on performance (pro-rated based on degradation)	

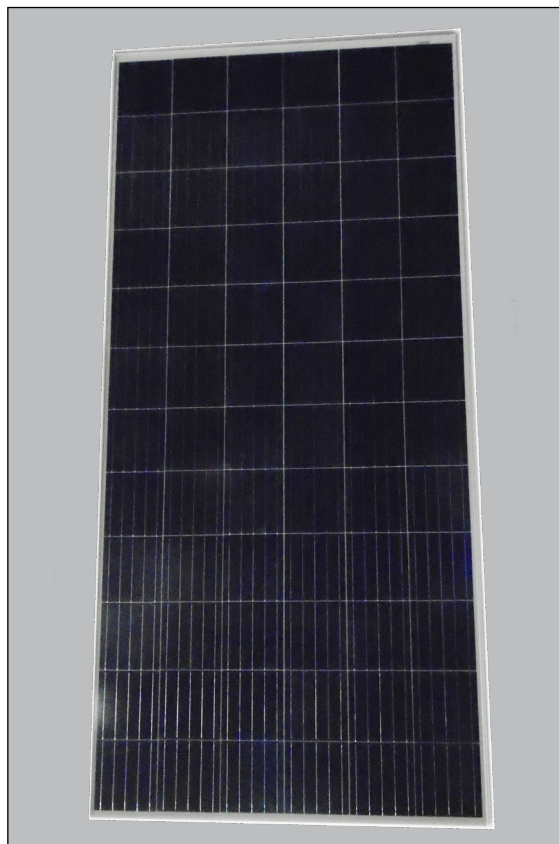

(Module 020295)

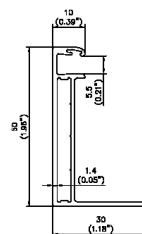
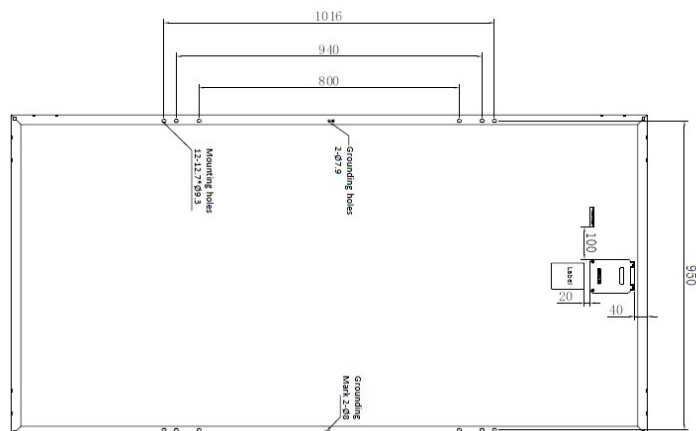

Section View of Frame

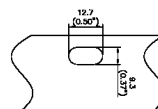

Mounting Hole

SHOP NOW



Headquarters
30893 Ehlen Dr Sw
Albany, OR 97321
(866) 827-6527

